



THE PURSUIT OF WELL-BEING

An American-style villa on the outskirts of Venice boasts a swimming pool and two wood-burning fireplaces that recreate the perfect atmosphere all year round

When the entrepreneur Massimo Scatto decided to buy this villa, he was going through some major changes in his professional and personal life. After working as a sales manager for a multinational company for several years, constantly travelling for work and returning home briefly just for the weekend, he decided to set up his own business, with a few employees and the convenience of having an office just 10 minutes away.

Located in a residential area on the outskirts of Venice, the house was designed by architect Roberto Driusso (Driusso Associati). This white, light-filled building, with large full-height windows and a deliberately simple structure, is reminiscent of the single-family detached houses designed by the architect Richard Meier.



At the time of purchase, only the external envelope had been built and the owner had the chance to customise the garden and interiors with one main goal: to recreate an oasis of relaxation and well-being, where he could always feel as if he were on holiday, all year round.

The **outdoor area** – roughly 1,000 square metres – now houses a 12x4 metre swimming pool, which takes up part of the garden, but is frequently used in summer by the whole family.

Inside there are three levels, covering a total area of 300 square metres.

The **basement** is used as a recreational and leisure area: it has a sitting room with TV, a dining room, guest rooms and a garage.

On the **ground floor** there is a large open space area of approximately 110 square metres, including a living room, dining room and kitchen.

A steel and glass staircase leads up to the **first floor**, where the sleeping area is located. The interior design has been carefully planned to ensure plenty of natural light. On the ground floor and first floor, large double height windows open onto the pool, creating continuity between the outdoor and indoor spaces, making the villa seem much more spacious. In the basement, an inner courtyard offers ample natural light in a space that would otherwise have been rather dark.



The interior design, chosen by the owner himself, is a combination of simplicity and sophistication thanks to the perfect balance of materials (mainly iron, wood and glass).

The wood-burning fireplaces play a crucial role in creating a special atmosphere, something the owner was keen to achieve primarily for aesthetic reasons rather than for heating reasons. The fireplaces, both from **MCZ's Plasma collection**, have been designed for the two areas of the house dedicated to spending time together, namely the basement and the living area.

A **three-sided model (Plasma 95T)** was installed in the basement, ideally separating the dining area from the relaxation area. The flame is visible from anywhere in the room, making it the distinctive element that adds character to the entire room.

An equally important element is the large **front fireplace** installed in the living area on the ground floor, which uses natural convection (**Plasma 115**). In the cladding, made of fireproof plasterboard, storage niches have been realised on the right side and, on the front next to the fireplace, there is an iron-clad wood holder, which forms an interesting vertical section that creates discontinuity with the front and adds a warm touch of colour thanks to the logs.

PROJECT DETAILS

Private house, on the outskirts of Venice

Date: 2016

Building design: architect Roberto Driusso, Driusso Associati Architetti, Mestre (Venice)

Fireplace project: architect Paola Cesaro, project consultant for MCZ Group

Installation: Zanella SNC, Ponzano Veneto (Treviso)

Systems: Underfloor heating system, underfloor cooling combined with dehumidifier system and air recirculation. Condensation boiler with heat pump. Heat pump for cooling. Photovoltaic system.

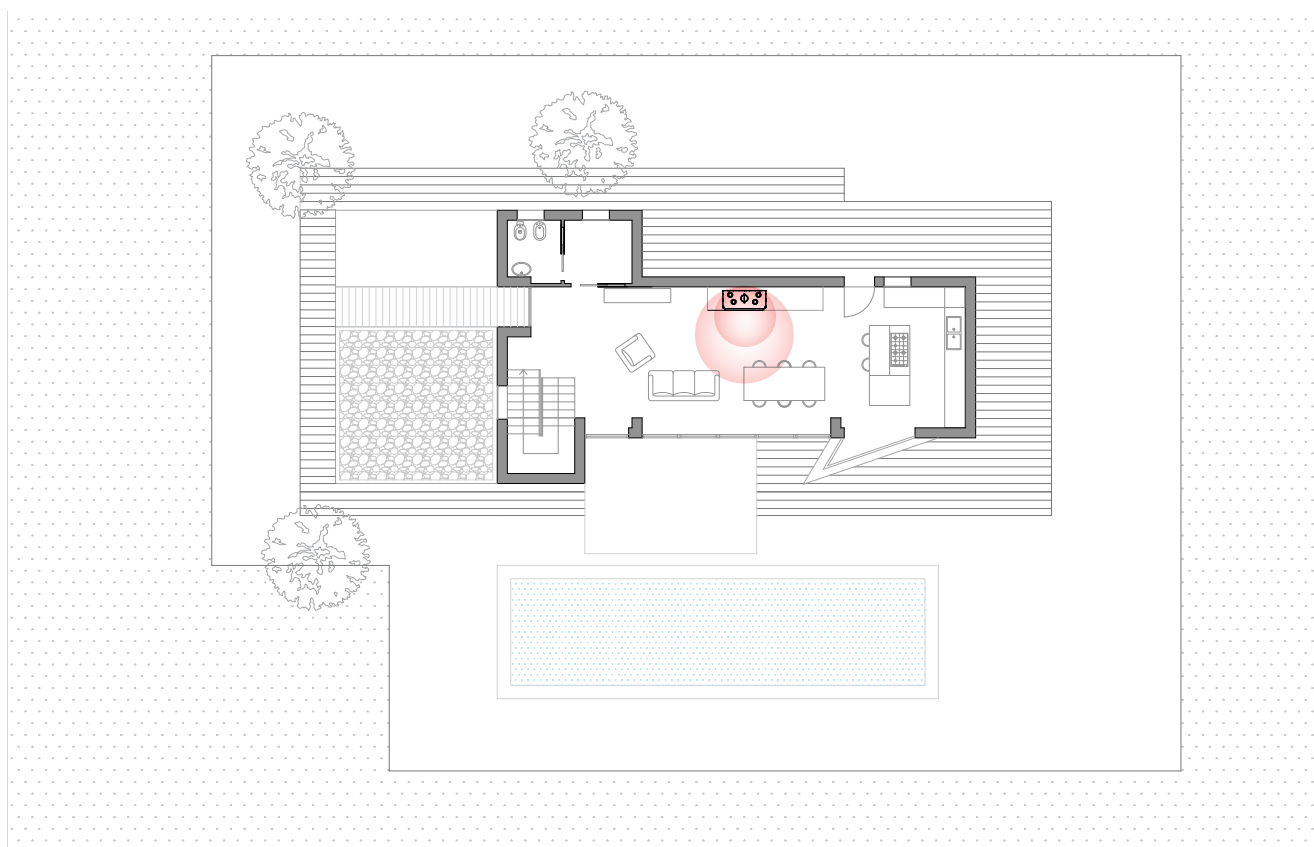



Plasma fireplaces by MCZ – Characteristics

Plasma is the new range of wood-burning fireplaces, which ensure superior environmental performance.

Thanks to an airtight combustion chamber and accurate air flow control, emissions are reduced to a minimum, thus ensuring the same performance and efficiency as with pellet appliances.

Moreover, the Plasma fireplace is extremely easy to use. The “Easy Going” system allows you to automatically adjust the flame by using a simple and intuitive cursor positioned on the bottom frame of the fireplace. Its 5 positions are designed for real everyday situations. For example, all you need to do is set it on “start” for quick ignition of the flame, or on “sleep” to minimise wood consumption for combustion with very little oxygen.

Plasma fireplaces are designed to guarantee maximum exploitation of the heat, whether natural convection is used, or forced ventilation is the preferred choice. All Plasma fireplaces can be teamed with the patented COMFORT AIR® system, that makes it possible to convey the hot air to several rooms, even unconnected or on different floors.

The Plasma collection comprises:

- four front models, which can be either 75, 85, 95 or 115 centimetres wide
- two double-sided models, either 95 or 115 centimetres wide
- two three-sided models, either 50 or 95 centimetres wide
- two corner models, either 75 or 95 centimetres wide



You can download the images presented in the press release and the text by clicking on the following link:

http://www.ergo-online.it/press/MCZ_Venice_PrivateHouse.zip

International Press Office:
ERGO _ Piazza Piemonte 8
20145 Milano, Italy _ Tel. +39/02/43995057
info@ergo-online.it _ www.ergo-online.it